

REV.	DESCRIPTION	DATE	DRAWN
A	New	10.11.2006	RH
D	correct layout 2.84->2.54mm	09.05.2017	Ryan
E	general update	27.02.2018	Ronny
F	update	06.08.2019	Ronny

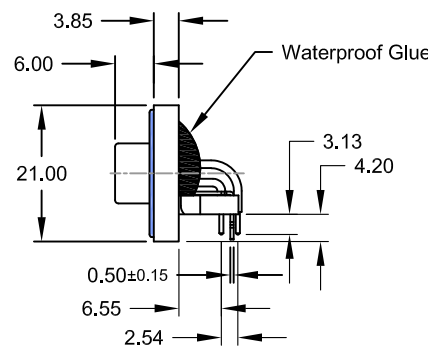

Order Code
SDM-xxx-NIP7-55/B2TXX

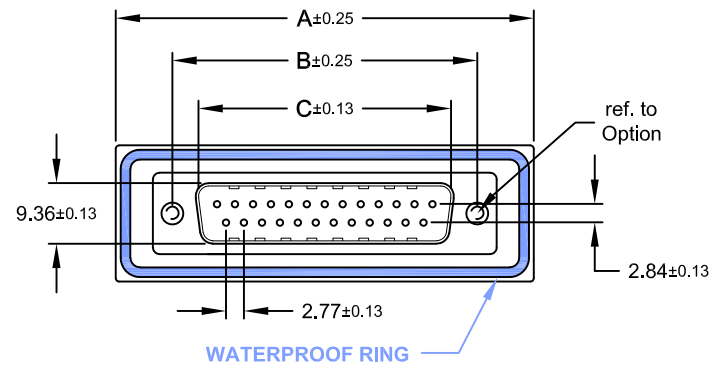
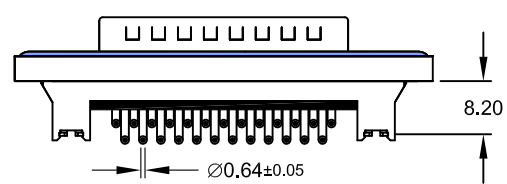

Dimension mm					No. of Contact
A	B	C	D	E	
39,40	24,99	16,92	20,00	28,20	009
47,70	33,32	25,25	28,00	36,50	015
64,50	47,04	38,96	41,50	51,00	025

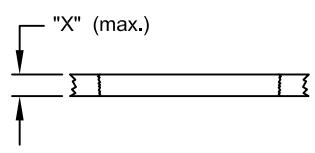
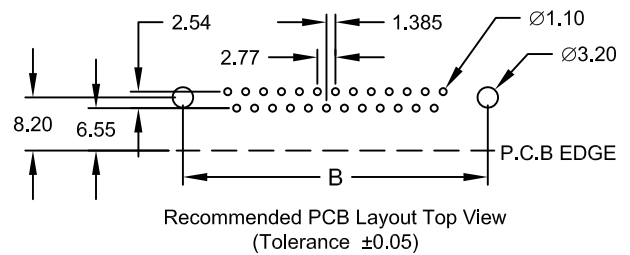
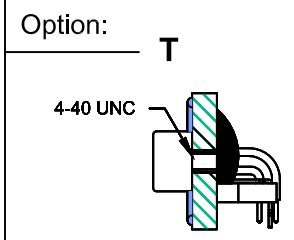

Panel Thickness
Screw "L" = 5.70 for Panel thickness "X" between 1.20~2.00mm

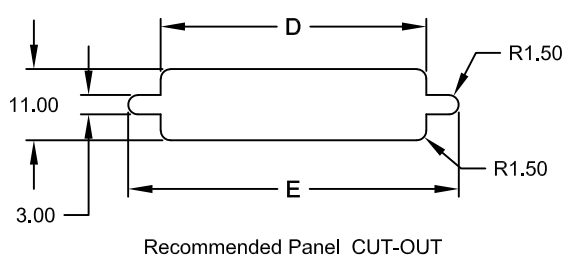
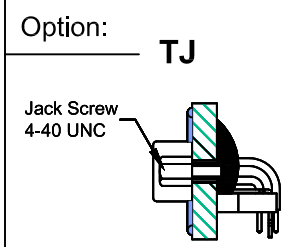
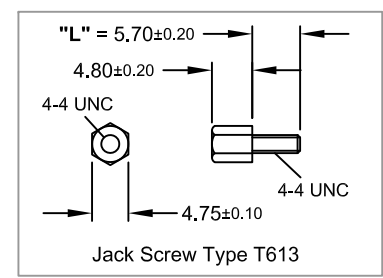

Specifications
Electrical
Current rating: 5A
Insulation resistance: 5000MΩ min.
Contact resistance: 10mΩ max.
Voltage rating: 250V AC rms max.
Withstanding voltage: 1000V AC rms

Material
Contact: Brass
Plating: Au flash over Ni
Insulator: PBT UL 94V-0
Shell: Steel
Plating: Ni

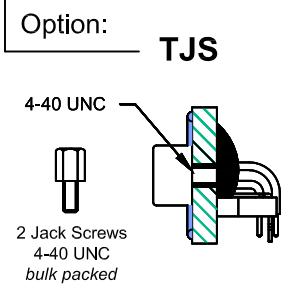

Operating temperature: -55°C to +85°C
Salt Spray: 48 Hours
Waterproof rating: IP 67 min.

E-tec 2019 © - all rights reserved www.e-tec.asia

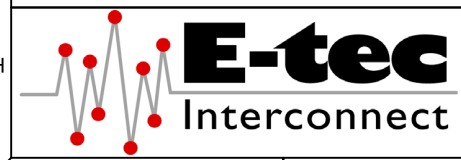

UNIT	mm	GENERAL TOLERANCE		DRAWN	DATE
SCALE	Free	X.° ±	X. ±	RH	10.11.2006
		.X° ±	.X ±	CHECK	Ronny
		.XX° ±	.XX ± 0.25	APPROVE	Fagi
		.XXX° ±	.XXX ±		06.08.2019

DWG. NO.	SHEET 1/1
SDM-NIP7/B2T	REV. F
SERIES NO.	
SDM-xxx-NIP7-55/B2TXX	

Waterproof D-Sub
Standard "Male"
Right Angle Type with Brackets