

No. of Pins	Dimension mm	
	L1	L2
004	5.08	2.54
006	7.62	5.08
008	10.16	7.62
010	12.70	10.16
012	15.24	12.70
014	17.78	15.24
016	20.32	17.78
018	22.86	20.32
020	25.40	22.86
022	27.94	25.40
024	30.48	27.94
026	33.02	30.48
028	35.56	33.02
030	38.10	35.56
032	40.64	38.10
034	43.18	40.64
036	45.72	43.18
038	48.26	45.72
040	50.80	48.26
042	53.34	50.80
044	55.88	53.34
046	58.42	55.88
048	60.96	58.42
050	63.50	60.96
052	66.04	63.50
054	68.58	66.04
056	71.12	68.58
058	73.66	71.12
060	76.20	73.66
062	78.74	76.20
064	81.28	78.74
066	83.82	81.28
068	86.36	83.82
070	88.90	86.36
072	91.44	88.90
074	93.98	91.44
076	96.52	93.98
078	99.06	96.52
080	101.60	99.06

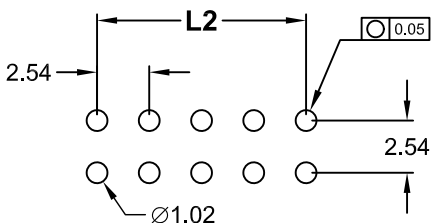
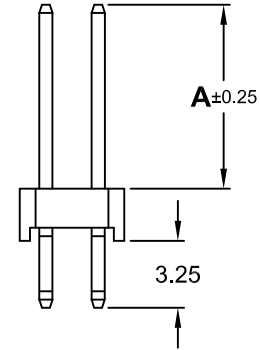
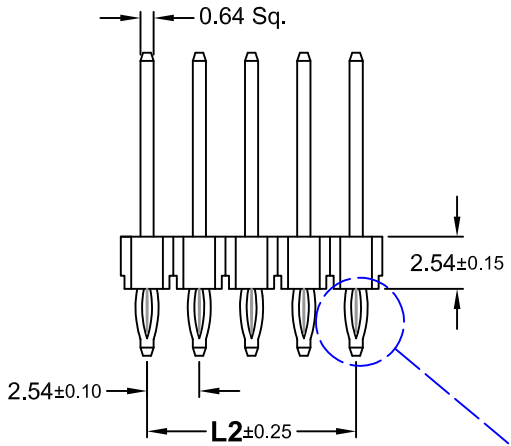
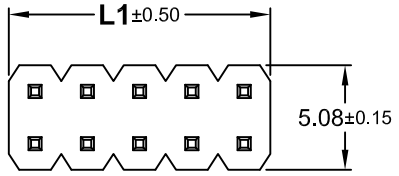

Recommended PCB Layout Top View  
(Tolerance ±0.05)

REV.	DESCRIPTION	DATE	DRAWN
A	New	29.01.2019	Cherry
D	add Pin code "302/01"	12.09.2019	Cherry
E	add color option	19.09.2019	Cherry
F	general update & add PCB Ø1.02 & Brass→ PhBz	27.08.2021	Ronny

### Order Code

## SL2-xxx-SHP X xxx/xx-xx

No. of Pins  
**004 to 080**  
see table

Plating  
**55** = Gold flash (Standard)  
**95** = Tin/Gold flash  
**99** = Tin  
*others on request*

Color option  
**no suffix = black**  
**nature = A**

Pin Code	Dim."A" (mm)
121/02	6.30
290/01	23.20
298/01	24.00
302/01	24.40
other Dimension on request	

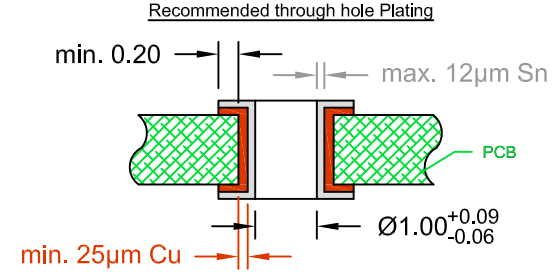

### Specifications

**Electrical**  
Current rating: 3A  
Insulation resistance: 5000MΩ min.  
Contact resistance: 20mΩ max.  
Voltage rating: 230V AC max.  
Withstanding voltage: 500V AC / Minute

**Material**  
Contact: Phosphor Bronze  
Plating: Gold flash or Tin plated  
Insulator: PA6T (black) UL 94V-0  
Operating temperature: -40°C +105°C



E-tec 2021 © - all rights reserved www.e-tec.asia



UNIT	mm	GENERAL TOLERANCE		DRAWN	DATE	DWG. NO.	SHEET 1/1
SCALE	Free	X.° ±	X. ±	Cherry	29.01.2019	SL2-SHP	REV. F
		.X° ±	.X ±	Ronny	27.08.2021	SERIES NO.	
		.XX° ±	.XX ± 0.25	Fagi	27.08.2021	SL2-xxx-SHPXxxx/xx-xx	
		.XXX° ±	.XXX ±				

**"Press Fit" Pin Header**  
**2.54mm pitch**  
Dual Row - Straight